



TRADE PRICELIST SECTION 7: TRANSPALINK CLEAR SYSTEM & GRILLES



Portico Products

Unit 8 Union Park
Navigation Way, Oldbury Road
West Bromwich, West Midlands
B70 9DF

telephone: 0121 553 7222
fax: 0121 553 3577
email: sales@porticoproducts.com
website: www.porticoproducts.com



NOTES:

- All prices are nett GBP ex works plus carriage* plus VAT
- All orders are subject to our standard terms & conditions as laid out in our TRADE PRICELIST SECTION 10 and available on request
- If you can't see the item you want, please call our sales department - as well as stocked items we have access to a huge range of products bought in to order
- Quantity discounts are available for most products
- Quantity discounts are generally awarded on an order by order basis, however some may be available for call-off orders - please ask our sales team for details

*carriage and packing as laid out in our TRADE PRICELIST SECTION 10

TRANSPALINK TRANSPARENT SHUTTER SYSTEM

		LENGTH	
TPLINK	Transparent link		2.60/ea
TPTUBE	Aluminium tube (link connector)	8.0	1.29/mtr
TPCAP	Black plastic endcap (endlock)		0.43/ea
TPSPA	Black plastic spacer for cut links		0.32/ea
TPCONA	Lath converter A for steel laths (NOTE THIS ITEM IS ALUMINIUM)		0.45/ea
TPJOIN	Joining fitment to save on tube scrap		0.55/ea
		LENGTH	
TPGUIDE	90mm galv. steel guide c/w brushstrips	6.0	99.00/len
TPBRA	Anodised aluminium bottom rail c/w seal	6.0	125.00/len

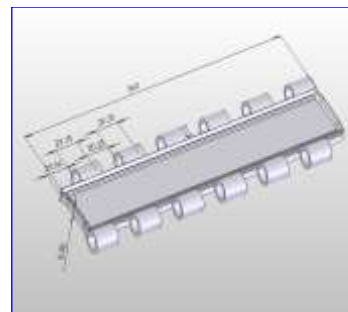

TRANSPALINK TECHNICAL INFORMATION

LINK DIMENSIONS:	360mm wide x 85mm working height
LINKS / SQUARE METRE:	32.7 (35)
BOTTOM RAIL HEIGHT:	85mm (working height including rubber)
GUIDE DEPTH:	90mm Steel
ALUMINIUM TUBE:	16mm o/d, 7m lengths
WEIGHT OF CURTAIN:	9.5kg/m ²
COIL TUBE REQUIREMENT:	4" minimum
MAXIMUM RECOMMENDED DIMENSIONS:	6000mm wide and 4000mm high

PLATE SIZES:

OPENING HT/mm	Using 4" tube	Using 5" tube
2000	14"	14"
2500	14"	15"
3000	14"	15"
3500	15"	16"
4000	15"	16"

CUT SIZE CALCULATIONS:

Thickness of endcaps:	3mm
Thickness of guide wall:	3mm
Therefore calculation is:	BOG - ((2x3)+(2x3)+clearance*)

For example

A door with 3000mm BOG dimension would give:

$$3000 - ((2 \times 3) + (2 \times 3) + (2 \times 6))$$

$$3000 - (6 + 6 + 12)$$

$$3000 - 24 = 2976\text{mm}$$

*NOTE what clearance to leave is up to you the manufacturer, but we would suggest between 5 and 10mm

Please use the grid opposite to simplify your quotation process. Parts Included for are:

- Links
- Link Connecting Tubes
- Bottom Rail c/w seal
- Plastic Endcaps & Spacers

All other parts should be added using the prices above and referring to other sections of our TRADE PRICELIST. (for example made up motorised roller barrels are in SECTION 1: ELECTRICAL / ELECTRONIC PARTS)



TRANSPALINK CURTAIN PARTS ONLY PRICING GRID

Please use the grid below to simplify your quotation process. Parts included for are:

- Links
- Link Connecting Tubes
- Bottom Rail c/w seal
- Plastic Endcaps & Spacers

All other parts should be added using the prices on page 7.2 in this section and referring to other sections of our TRADE PRICELIST. (for example made up motorised roller barrels are in SECTION 1: ELECTRICAL / ELECTRONIC PARTS)

LINKS WIDE	3	4	5	6	7	8	9	10	11	12	13	14	15	16	17	18	19	
CUT CURTAIN WIDTH	1080	1440	1800	2160	2520	2880	3240	3600	3960	4320	4680	5040	5400	5760	6120	6480	6840	
LINKS GUIDE																		
HIGH HEIGHT																		
17	1445	252	332	411	474	569	632	694	846	909	972	1035	1098	1161	1223	1286	1349	1412
19	1615																	
21	1785	299	390	479	553	667	741	815	993	1068	1141	1215	1289	1363	1436	1511	1584	1658
23	1955																	
25	2125	345	446	555	641	765	851	936	1141	1225	1310	1395	1481	1565	1650	1735	1820	1904
27	2295																	
29	2465	384	504	624	720	864	960	1055	1288	1384	1479	1576	1672	1767	1863	1958	2054	2150
31	2635																	
33	2805	431	562	693	799	963	1069	1176	1435	1542	1650	1756	1863	1969	2076	2182	2289	2396
35	2975																	
37	3145	478	620	770	887	1061	1178	1296	1583	1701	1819	1936	2054	2171	2289	2407	2524	2642
39	3315																	
41	3485	516	677	838	966	1159	1288	1416	1730	1860	1988	2116	2245	2373	2502	2630	2758	2888
43	3655																	
45	3825	563	734	906	1046	1258	1398	1537	1878	2017	2157	2296	2436	2576	2714	2854	2994	3133
47	3995																	
49	4165	609	792	983	1133	1357	1507	1657	2025	2176	2326	2477	2627	2777	2927	3079	3229	3379
51	4335																	
53	4505	648	849	1051	1213	1454	1616	1778	2172	2334	2496	2657	2818	2980	3141	3302	3464	3625
55	4675																	
57	4845	694	907	1119	1292	1553	1725	1897	2321	2493	2665	2837	3009	3182	3354	3526	3698	3870
59	5015																	
61	5185	741	965	1196	1380	1652	1834	2018	2468	2650	2834	3017	3200	3383	3567	3750	3933	4116
63	5355																	
65	5525	779	1022	1265	1458	1750	1944	2138	2615	2809	3003	3197	3392	3586	3780	3974	4169	4363
67	5695																	
69	5865	826	1079	1334	1538	1848	2054	2259	2763	2967	3172	3378	3583	3787	3993	4198	4403	4608

NB THE RECOMMENDED MAXIMUM SIZE FOR TRANSPALINK SHUTTERS IS 6000mm W X 4000mm HIGH. GRID PRICES OUTSIDE THIS AREA ARE FOR INFORMATION ONLY

*NOTE THAT CUT WIDTHS OVER 6000mm WILL MEAN THAT THE BOTTOM RAIL SECTION WILL NEED TO BE JOINED

PLASTIC GRILLE LINKS

GRLINKP-M	Plastic Main Link Available from stock in WHITE, BLACK, BROWN*	POA
GRLINKP-TB	Plastic Top/Bottom Link Available from stock in WHITE, BLACK, BROWN*	POA
WASH1/4P	Plastic Rod Roller/Spacer Washer Available from stock in WHITE, BLACK, BROWN*	POA

*Please note that other colours are available for bulk orders

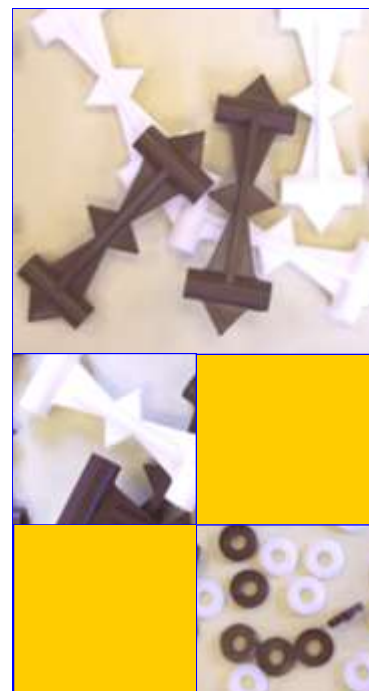

TUBES & LINKS

GRTUBE438	Aluminium Tube 4.3/8" (111mm) long x 1/2" o/d	125.00/1000
GRTUBE312	Aluminium Tube 3.1/2" (89mm) long x 3/8" o/d	111.00/1000
GRTUBE3	Aluminium Tube 3" (76mm) long x 3/8" o/d	94.50/1000
GRTUBE2	Aluminium Tube 2" (51mm) long x 3/8" o/d	74.00/1000
GRLINK234	Aluminium Link 2.3/4"crs x 5/8" x 1/8"	125.00/1000
GRLINK2	Aluminium Link 2"crs x 1/2" x 1/8"	84.00/1000
GRTUBEST	Steel Tube 4.3/8" (111mm) long x 1/2" o/d	202.50/1000
GRLINKST	Steel Link 2"crs x 1/2" x 1/8"	202.50/1000
ROLLER5/16P	Plastic Rod Roller/Spacer BLACK	0.10/ea



ACCESSORIES

VECAP	Post Locator/Endcap WHITE		5.00/ea
		LENGTH/m	
ROD1/4AL	1/4" o/d Aluminium Rod for Plastic Grilles	4,5,6	0.99/metre
ROD5/16AL	5/16" o/d Aluminium Rod for T & L Grilles	4,5,6	1.16/metre
ROD5/16S	5/16" o/d Steel Rod for T & L Grilles	4,5,6	1.16/metre



NOTE: FOR ALL GUIDES AND BOTTOM RAILS TO SUIT THESE SYSTEMS PLEASE REFER TO OUR TRADE PRICELIST SECTION 4: METAL SECTIONS